

# NEW ITEMS FEBRUARY / APRIL 2022

**METAL**  
+  
**PLASTIC PARTS**  
1 cm 2  
**1:32**

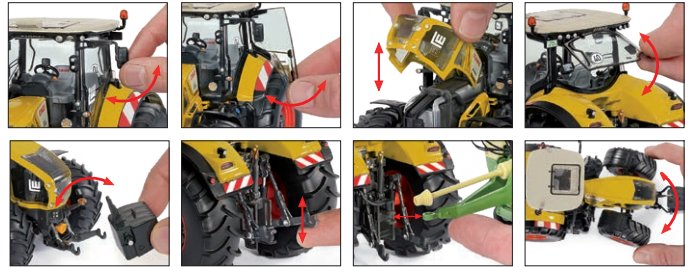

**0778 60 Claas Axion 930**  
In the service of road and rail construction



**0398 02 Normag Faktor I with plough**  
Small tractor of the post-war years  
1953-55



**0183 08 BMW 2002 turbo**  
The Bavarian way to bring horsepower to the road  
1973-74



**0125 02 DKW Cabrio**  
Open air fun in the Economic Miracle era  
1958-61



**0220 04 Chevrolet Malibu**  
US classic returning to the product selection  
1964-65



**1171 02 Forklift truck (Clark)**  
Pioneer in inventory turnover  
1952-56



**0493 01 Wagon-carrying road trailer Culemeyer (Faun)**  
Imposing bonnet truck of the federal railway  
1965-77



**0850 48 Hanomag with flatbed trailer**  
Favoured collector cycle modelled after Ruhr region originals  
1946-52



**0677 08 Rear tipper semi-truck (Magirus 235 D)**  
7,018 kilometre test drive from Munich to Kabul  
1963-71



**0457 04 Refrigerated road train (Volvo F88)**  
Finland - Italy 2 times a week  
1965-70



# NEW ITEMS FEBRUARY / APRIL 2022



**0971 02** Tour bus (MB O 302) N-gauge 1:160  
Passenger transport moving with the times



**0095 03** Trailer-mounted motor boat  
The upscale way to spend your days off  
1961-65



**0361 64** Fendt 1050 Vario  
The latest version of the Allgäu-made tractor



**0416 04** Platform trailer truck (MAN Pausbacke)  
Classic cab-over-engine combination  
1960-67



**0623 04** Fire brigade rescue vehicle (Magirus)  
Round hood designed to provide technical assistance  
1956-61



**0381 98** Claas Cargos forage trailer  
Version as a chaff transport wagon with road tyres



**0554 06** Stanchion trailer truck (MB)  
Long-goods hauling in Mercedes blue  
1968-71



**0514 07** Flatbed tractor-trailer (Henschel)  
Loyal Henschel customer of the 1960s  
1961-65



**1140 03** Self-build garage (3S)  
True-to-the-original prefabricated model of the sixties  
since 1967



**0990 99** Set „Magirus Baubullen“  
Trio of the last square hood generation from Ulm  
1970-74